

VR Owl specification

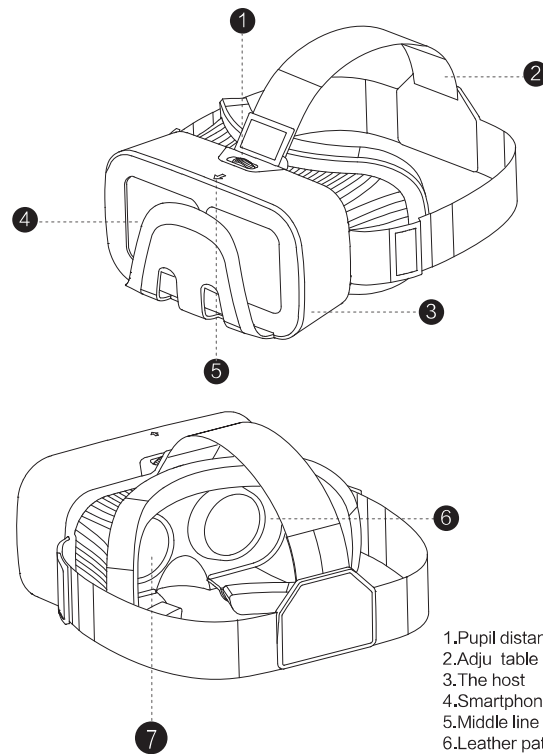

- 1.Pupil distance adjusting knob
- 2.Adjustable head band
- 3.The host
- 4.Smartphone cabin
- 5.Middle line
- 6.L Leather patch
- 7.Optical lens

VR Glasses specification

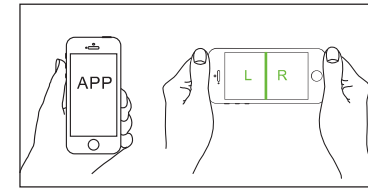

1 Download and play test video

Enter Android Market or App Store to download VR resources on mobiles (better under WIFI connection), select and install APP according to mobile system, download videos & games and test whether videos & games are split to screen left & right side (vis the figure at left) and played normally.

2 How to use the device.

After download and install the VR App successfully, open App and click the video you would like to watch, transverse placed smartphone, there is a middle line show in screen, then put smartphone in cabin, align the middle lines.

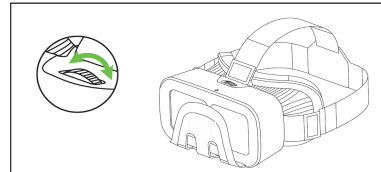
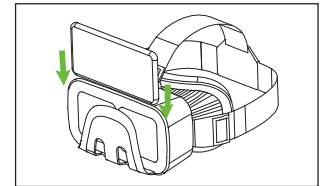

3 Adjustment function

You could make movie frame more clear by adjust interpupillary distance.

4 Introduction of game play

Two ways to play VR games:

A:VR games can be controlled by gyroscope of smartphone,Shaking or rotating head to manipulate games.(As shown in right picture)

B:VRgames can be controlled by bluetooth gamepad,move forward,Move backward,Turn left,Turn right and 360 degrees rotated.

Note:Most of VRgames can be controlled by gyroscope, No need Bluetooth gamepad,Whether Bluetooth gamepad is required or not,please refer to the game play tips.

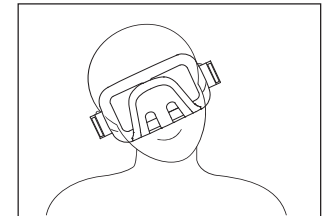

Thank for purchasing VR Owl glasses
Please check the detailed list.

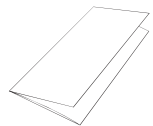

1pc manual

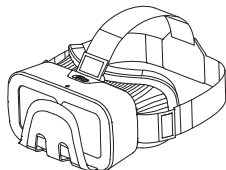

1pc device



FC RoHS

